

Report for: Record of Decision Taken Under Delegated Authority

Item Number:

Title: Proposed waiting and loading restrictions and parking place changes at 12 locations (Batch 27) across the borough

Request authorised by: Head of Service for Highways and Parking: Ann Cunningham



Lead Officer: Daniel Bingham
Parking Schemes
Level 1 (South), River Park House, 225 High Road,
Wood Green, N22 8HQ
daniel.bingham@haringey.gov.uk

Wards Affected: Woodside, Muswell Hill, Hornsey, Bounds Green,
Crouch End, Northumberland Park, Alexandra

Report for Key / Non-Key Decision: Non-key decision

1 Purpose

- 1.1 The purpose of this report is to provide details of the proposals, to report the responses received during the consultation period and to seek approval to proceed with the recommendations as set out in Section 11 of this report.
- 1.2 During January 2021, the Council undertook a statutory consultation on proposals to introduce waiting and loading restrictions and parking place changes at various locations across the borough as detailed in table 1 section 3.

2 Background

- 2.1 The Council receives many requests to introduce new, or to amend existing parking restrictions to address concerns relating to parking pressures including inconsiderate and obstructive parking. These concerns may originate from a variety of sources such as residents, businesses, elected representatives, community groups and other public service providers, or the emergency services.
- 2.2 Inconsiderate and obstructive parking can be a cause of concern to road users of all types. As well as affecting other motorists, it can result in reduced sight lines contributing to an increased risk of collisions impacting on the road safety of pedestrians and cyclists. Poorly parked vehicles may impede access and contribute to road congestion. This can impact on the movement of emergency services, public transport, waste collection and larger delivery vehicles.

3 Proposals

- 3.1 Table 1 below lists 11 locations where concerns or requests have been raised with regards to parking restrictions or parking places. Each location has been investigated and the table outlines the proposals we are seeking to approve. The designs for each location are contained within **Appendix 1**.

Table 1

Reference	Location	Description	Operation hours	Reason for proposal
(a)	Earlham Grove N22 - outside Cypriot Centre	Extend existing double yellow line with double kerb blips (no waiting or loading at any time) by 17 metres, therefore reducing the existing parking bay by 17 metres in length	At all times	To improve the visibility for vehicles manoeuvring Earlham Grove

Reference	Location	Description	Operation hours	Reason for proposal
(b)	Back Lane N8 - located at the rear of no. 12 Park Road N8	Extend existing double yellow line waiting restriction on Back Lane N8, located at the rear of no. 12 Park Road N8, by 13.5 metres in length	At all times	To provide space for a business to relocate their refuse bins to address air quality concerns for nearby residents
(c)	Willoughby Lane N17 - outside no. 99	Convert existing single yellow line waiting restriction, into a double yellow line waiting restriction	At all times	To improve the visibility and sightlines for pedestrians, cyclists and other road users manoeuvring Willoughby Lane
(d)	Willoughby Lane N17 - outside nos. 76 to 60	Convert existing single yellow line waiting restriction, into a double yellow line waiting restriction	At all times	To improve the visibility and sightlines for pedestrians, cyclists and other road users manoeuvring Willoughby Lane
(e)	Willoughby Lane N17 - opposite nos. 66 to 60	Convert existing single yellow line waiting restriction, into a double yellow line waiting restriction	At all times	To improve the visibility and sightlines for pedestrians, cyclists and other road users manoeuvring Willoughby Lane
(f)	Durnsford Road N11 - outside nos. 3 to 5	Convert existing single yellow line waiting restriction, into a double yellow line waiting restriction 3.5 metres in length	At all times	To help maintain clear access for residents

Reference	Location	Description	Operation hours	Reason for proposal
(g)	Tottenham Lane N8 - opposite the entrance to Cranford Industrial Estate	Convert existing pay by phone bay into a motorcycle bay, 5 metres in length	At all times	To provide parking space for motorcycles in order to keep other nearby parking bays free for other road users
(h)	Priory Road N8 - outside no. 179 to 185A	Introduce a loading only bay	Monday to Sunday between 6am-9am and 6pm-9pm with a maximum stay period of 1 hour and no return time of 2 hours	To provide unloading/loading opportunities for nearby businesses
(j)	Crescent Road N22 and Dagmar Road N22 - at the junction, both sides	Introduce double kerb markings loading restriction to existing double yellow waiting restriction	At all times	To improve the visibility and sightlines for pedestrians, cyclists and other road users manoeuvring the junction
(k)	Park Road N8 - outside no. 59	Remove loading bay, therefore extending the existing double yellow line waiting restriction by 12 metres in length		To provide adequate space on the footway for pedestrians

Reference	Location	Description	Operation hours	Reason for proposal
(l)	Back Lane N8 - located at the rear of no. 12 Park Road N8	Remove single resident permit bay		To provide space for a business to relocate their refuse bins in order to address air concerns for nearby residents

4 Statutory Notification

4.1 Statutory notification was undertaken on the proposals detailed in table 1 of section 3, on 06 January 2021 for a period of 21 days. This adheres to the legal requirements set out in section 7 of this report.

4.2 As part of the statutory process a Notice of Proposal was published in the London Gazette, Enfield and Haringey Independent. In addition, the notice was erected on site in the affected streets. The statutory notification consisted of 11 locations.

*See **Appendix 2** for a copy of the statutory notice of proposal that was advertised.

4.3 As part of the statutory process, the views of the following statutory bodies were also sought:

- AA
- London Transport
- Police (local)
- Fire Brigade
- London Ambulance Service
- Freight Transport Association
- Road Haulage Association
- RAC
- Metropolitan Police (traffic)
- London Travel Watch
- Haringey Cycling Campaign

See **Appendix 3** for a copy of e-mail sent to the above statutory bodies.

5 Statutory Notification Feedback

5.1 No objections have been received on any of the proposals.

6 Chief Financial Officer Comments

6.1 The capital costs of waiting, loading, and parking place measures outlined in this report can be met from the Parking Plan funding which forms part of the 2021-2022 budget.

7 Legal Requirements

7.1 Before reaching a decision to make the necessary Traffic Management Order to implement or amend a CPZ scheme, the Council must follow the statutory consultation procedures pursuant to the Road Traffic Regulation Act 1984 ("RTRA") (as amended) and the Local Authorities Traffic Orders (Procedure) (England and Wales) Regulations 1996 (as amended). In carrying out the **notification the council must comply with the principles ("Sedley Principles") set out also by the courts which are: that notification must be at a time when proposals are still at a formative stage; that the proposer must give sufficient reasons for any proposal to permit of intelligent consideration and response; that adequate time must be given for consideration and response; and that the product of notification must be conscientiously taken into account in finalising any statutory proposals. All objections received must be properly considered in the light of administrative law principles, Human Rights law and the relevant statutory powers.**

7.2 The Council's powers to make Traffic Management Orders arise mainly under sections 6, 9, 45, 46, 122 and 124 and schedules 1 paragraph 8 and 9 of the RTRA.

7.3 By virtue of section 122, the council must exercise its powers under the RTRA 1984 so as to secure the expeditious, convenient and safe movement of vehicular and other traffic including pedestrians, and the provision of suitable and adequate parking facilities on and off the highway. These powers must be exercised so far as practicable having regard to the following matters: -

- (a) The desirability of securing and maintaining reasonable access to premises.
- (b) The effect on the amenities of any locality affected including the regulation and restriction of heavy commercial traffic so as to preserve or improve amenity.
- (c) The national air quality strategy.
- (d) Facilitating the passage of public service vehicles and securing the safety and convenience of their passengers.

Any other matters appearing to the council to be relevant.

8 Comment of the Head of Legal Services

8.1 Other than the requirements set out in section 7 above there are no other legal implications arising out of this report.

9 Equal Opportunities

9.1 During the statutory notification period any interested parties are permitted to make representations regardless of the following protected characteristics: age, disability, gender reassignment or pregnancy and maturity.

9.2 The Council must, when carrying out the Council's functions (which includes making decisions), have due regard to the needs set out in section 149 of the Equality Act 2010 (the Public Sector Equality Duty ('PSED')). This duty includes having due regard to the need to advance equality of opportunity between persons who share a relevant protected characteristic (including people with a disability) and persons who do not share it. The Council must consider the duty, which is personal to decision makers.

10 Summary

The Council received no objections to the statutory consultation carried out on the 11 proposals listed in Table 1 of section 3.

11 Recommendations

11.1 It is recommended that the Head of Service for Highways and Parking approves all the proposals which includes the following:

11.2 Introduce parking place changes on the following roads: Earlham Grove N22, Tottenham Lane N8, Priory Road N8, Park Road N8 and Back Lane N8

11.3 Introduce changes to waiting restrictions on the following roads: Earlham Grove N22, Back Lane N8, Willoughby Lane N17, Durnsford Road N11, Rosebery Road N10, Park Road N8

11.4 Introduce loading changes on the following roads: Earlham Grove N22, Priory Road N8, Crescent Road N22 and Dagmar Road N22

11.5 To revoke existing waiting, loading and parking place restrictions to enable the introduction of the above changes.

12 List of Appendices

1. Detailed designs showing the extents of the proposals stated in section 3.1
2. Statutory notice of proposal proposing the measures stated in section 3.1
3. Statutory consultation notification email sent to statutory bodies stated in section 4.4

APPENDIX 1

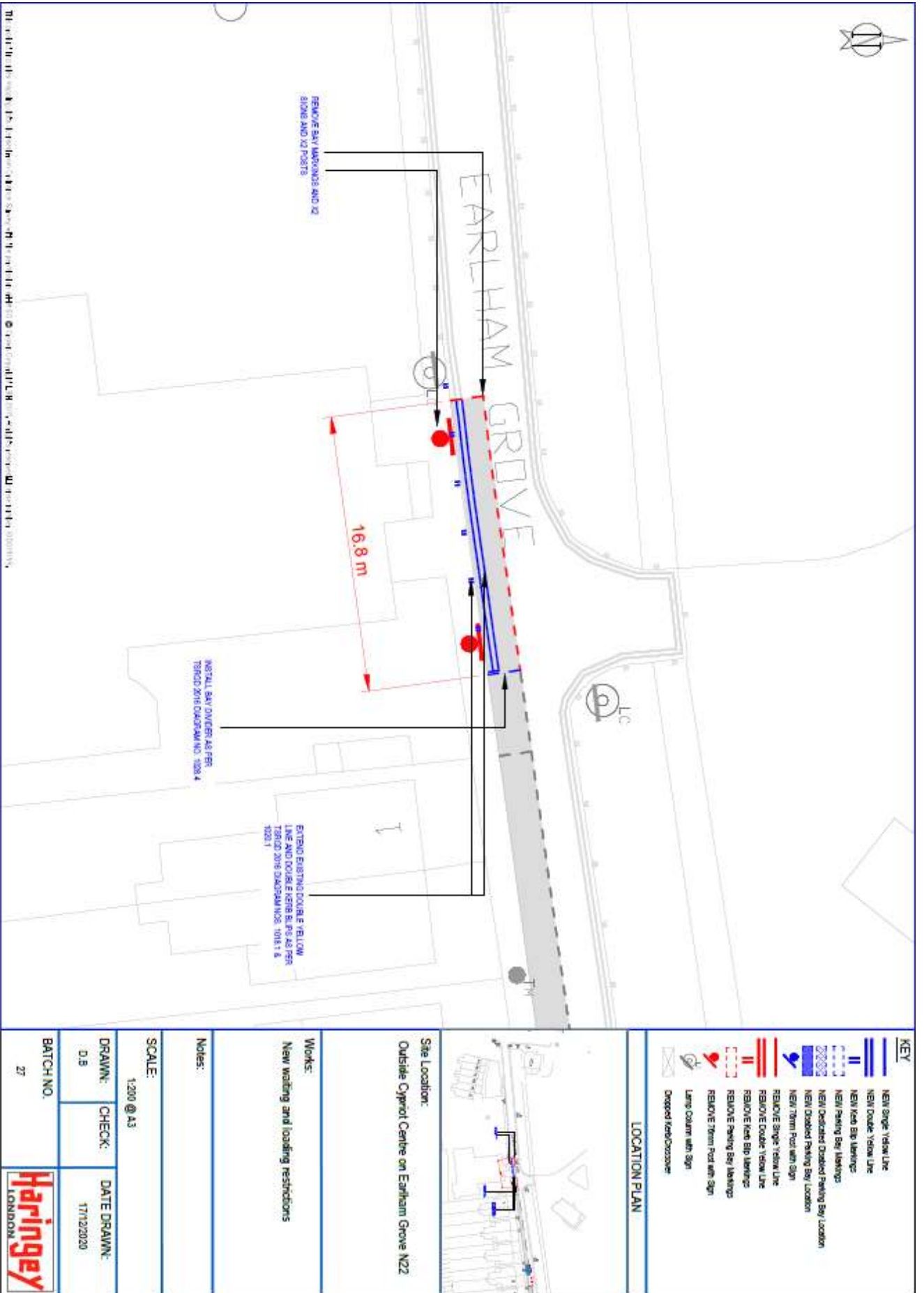

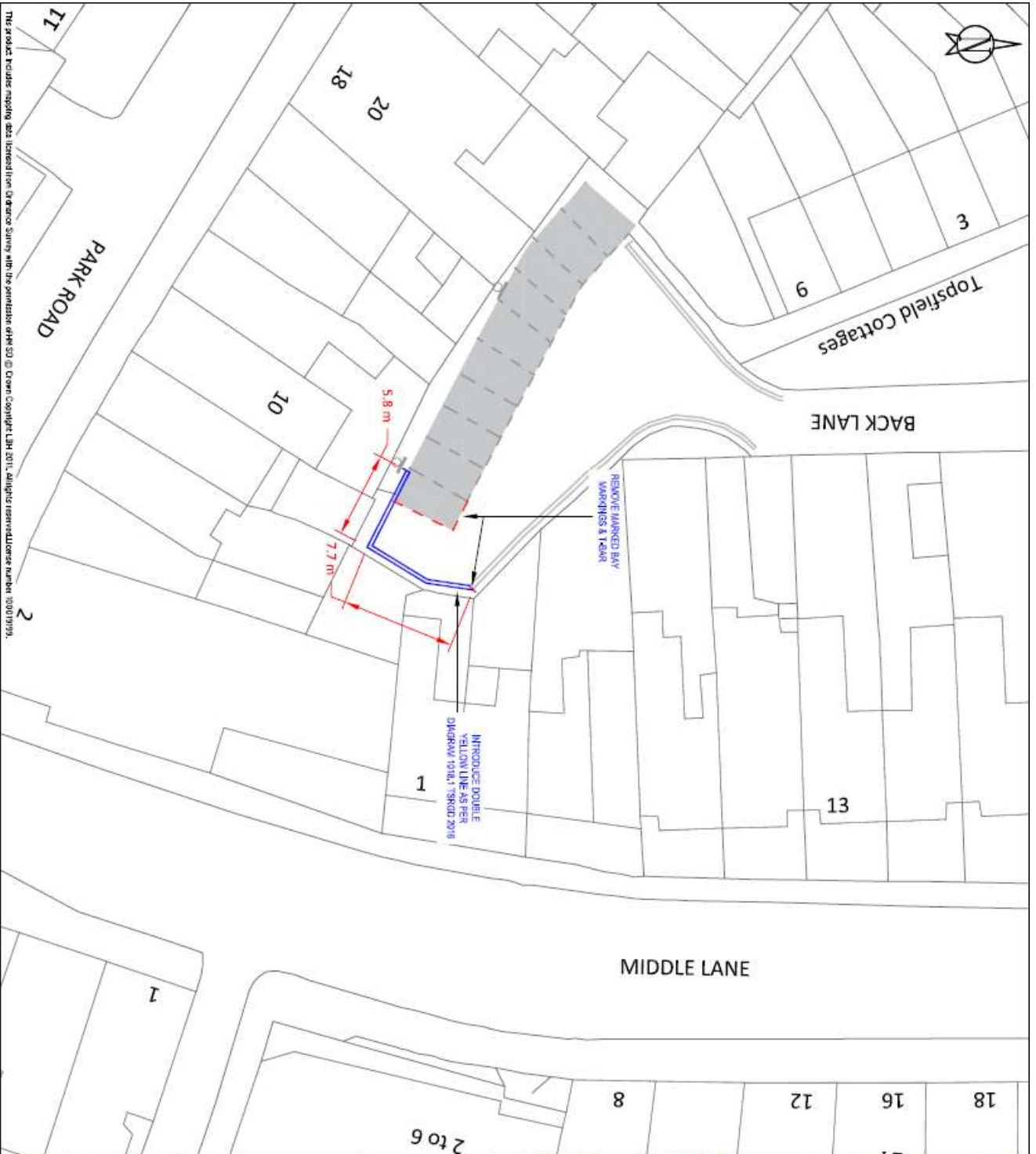

<p>KEY</p> <ul style="list-style-type: none"> NEW Single Yellow Line NEW Double Yellow Line NEW Kerb Slip Markings NEW Parking Bay Markings NEW Disabled Double Parking Bay Location NEW Double Parking Bay Location NEW Form Post with Sign REMOVE Single Yellow Line REMOVE Double Yellow Line REMOVE Kerb Slip Markings REMOVE Parking Bay Markings REMOVE Form Post with Sign Large Column with Sign Dropped Kerb/Coaster 	
<p>LOCATION PLAN</p>	
<p>Site Location: BACK LANE NB</p>	
<p>Works: REDUCE PARKING BAY & EXTEND DOUBLE YELLOW LINES</p>	
<p>Notes:</p>	
<p>SCALE: 1:200 @ A3</p>	
<p>DRAWN: AK</p>	<p>CHECK: JOK</p>
<p>DATE DRAWN: 22/12/2020</p>	
<p>BATCH NO. 27</p>	

The product includes mapping data licensed from Ordnance Survey with the permission of HM SO. © Crown Copyright. LHA 2011. All rights reserved. Licence number 100019193.



REMOVE YELLOW LINES UNDER IMPERIAL HOUSE
DRAWING NO. 2018

CONVERT EXISTING SINGLE YELLOW LINES INTO DOUBLE YELLOW LINES AS PER THRESH 2018 DRAWING NO. 1018.3

KEY	
	NEW Single Yellow Line
	NEW Double Yellow Line
	NEW Keel Bay Markings
	NEW Parking Bay Markings
	NEW Dedicated Disabled Parking Bay Location
	NEW 7ftm Foot with Sign
	REMOVE Double Yellow Line
	REMOVE Single Yellow Line
	REMOVE Keel Bay Markings
	REMOVE Parking Bay Markings
	REMOVE 7ftm Foot with Sign
	Lamp Column with Sign
	Deleted Keel/Crossover



- Site Location:**
1. Corner 88 Willoughby Lane N/T
 2. Corner 78 to 88 Willoughby Lane N/T
 3. Opposite 60 to 80 Willoughby Lane N/T

Works:
Convert single yellow lines to double yellow lines

Notes:

SCALE:

DRAWN:	CHECK:	DATE DRAWN:
DB		30/11/2020
BATCH NO.		
27		



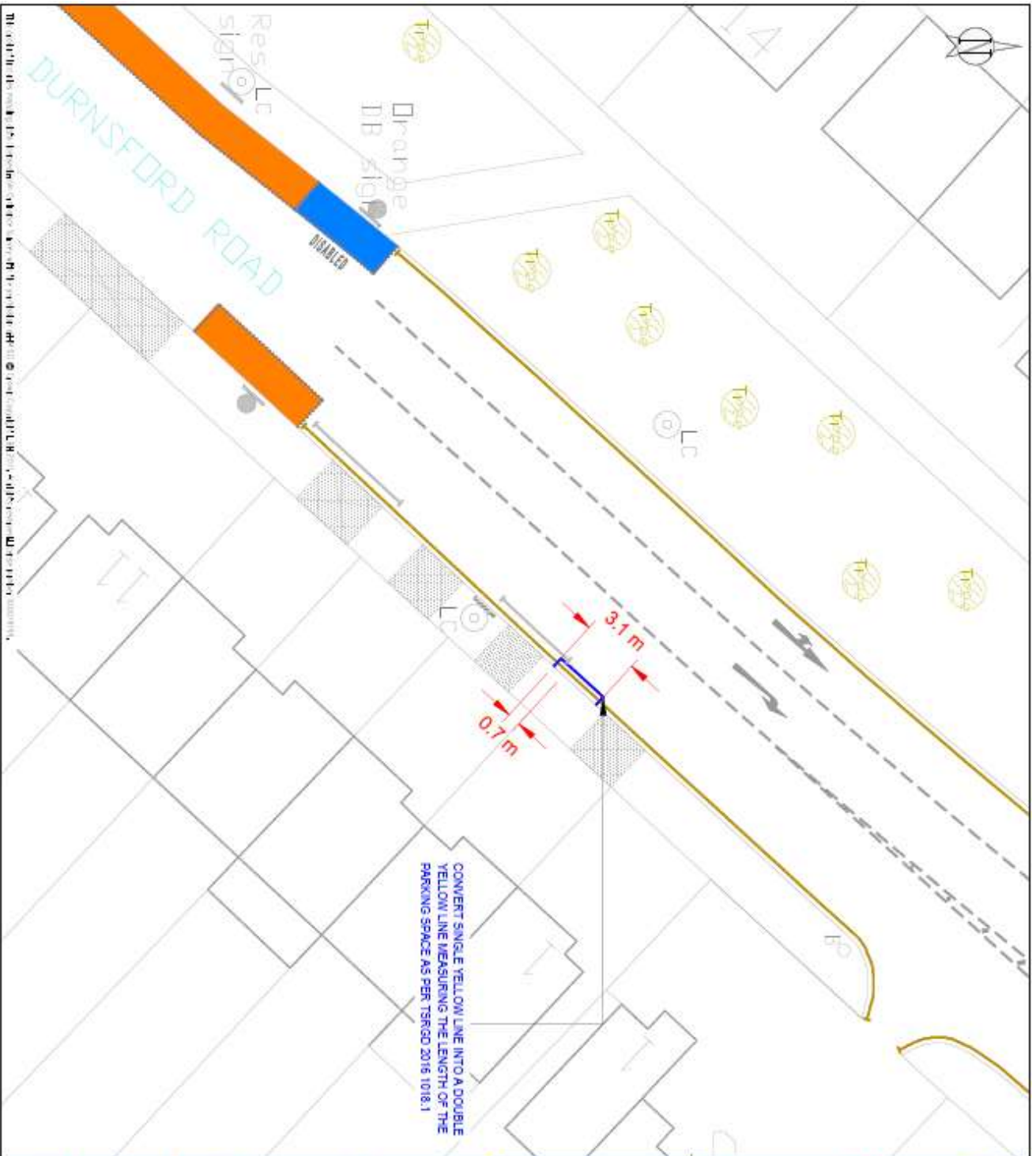

KEY	
	NEW Single Yellow Line
	NEW Double Yellow Line
	NEW Kele Bay Markings
	NEW Parking Bay Markings
	NEW Dedicated Disabled Parking Bay Location
	NEW Disabled Parking Bay Location
	NEW Term Post with Sign
	REMOVE Single Yellow Line
	REMOVE Double Yellow Line
	REMOVE Kele Bay Markings
	REMOVE Parking Bay Markings
	REMOVE Term Post with Sign
	Lamp Column with Sign
	Droped kerb/Decrease

LOCATION PLAN

Site Location:
Outside no. 5 Durnsford Road N11

Works:
Convert a small section of single yellow line into a double yellow line

Notes:
Measure from the boundary line of property nos. 3 and 5

SCALE:
1:200 @ A3

DRAWN: D.B	CHECK:	DATE DRAWN: 16/12/2020
BATCH NO. 27		

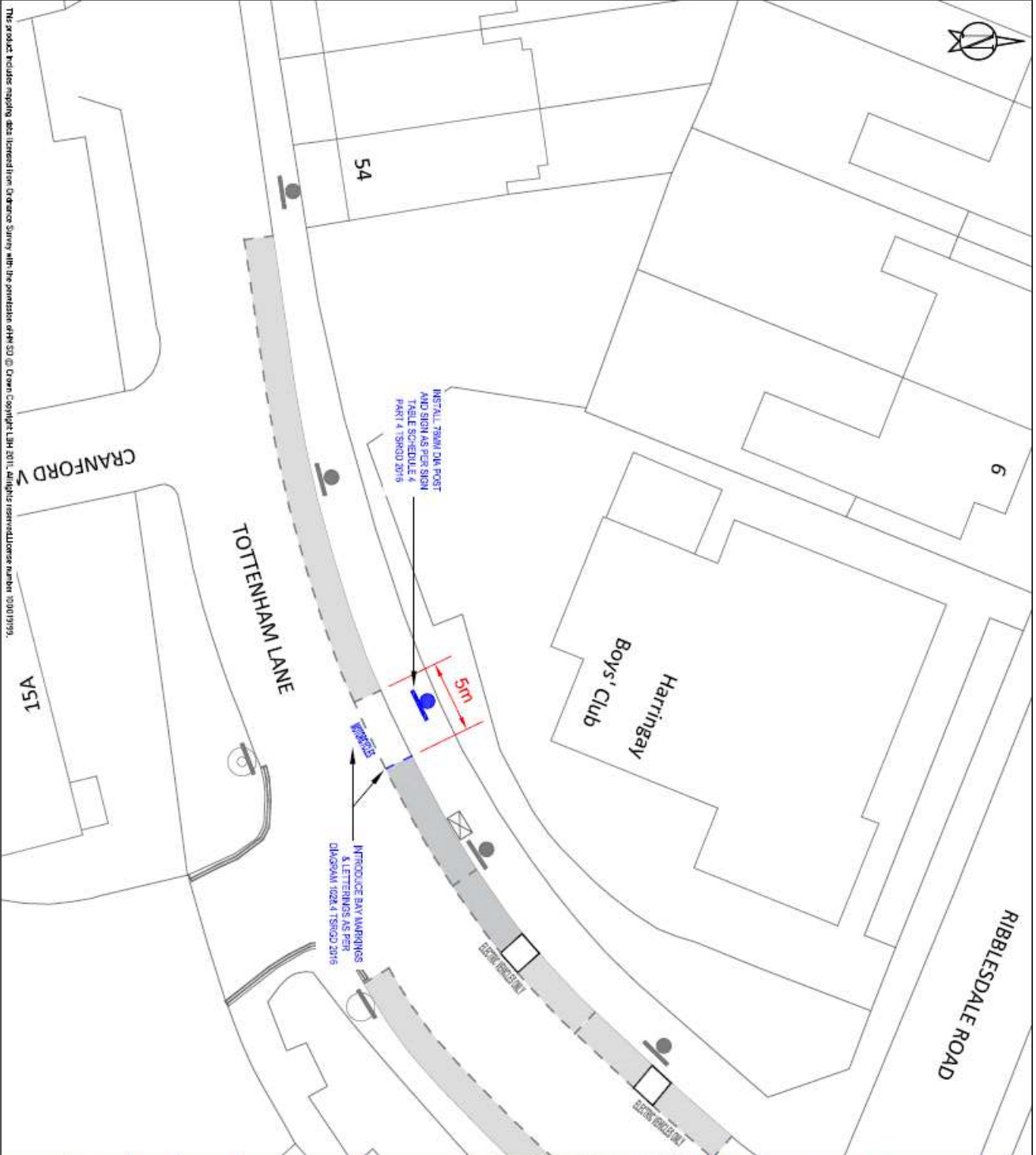

The product includes mapping data licensed from Ordnance Survey with the permission of HMSO © Crown Copyright, LHM 2011, all rights reserved. Licence number 100019199.

<p>KEY</p> <ul style="list-style-type: none"> — New Single Yellow Line — New Double Yellow Line — New Keo BIP Markings — New Parking Bay Markings — New Double Yellow Line Parking Bay Location — New Keo BIP Markings Parking Bay Location — New Tram Post with Sign — Remove Signs Yellow Line — Remove Double Yellow Line — Remove Keo BIP Markings — Remove Parking Bay Markings — Remove Tram Post with Sign — Lamp Column with Sign — Deleted Keo/Tram/Sign 	<p>LOCATION PLAN</p>	
	<p>Site Location: ADJACENT 54A TOTTENHAM LANE NB</p>	
<p>Works: CONVERT PART PBP BAY TO MOTORCYCLE PARKING BAY</p>		
<p>Notes:</p>		
<p>SCALE: 1:250 @ A3</p>		
<p>DRAWN: AK</p>	<p>CHECK: XX</p>	<p>DATE DRAWN: 22/12/2020</p>
<p>BATCH NO. 27</p>		

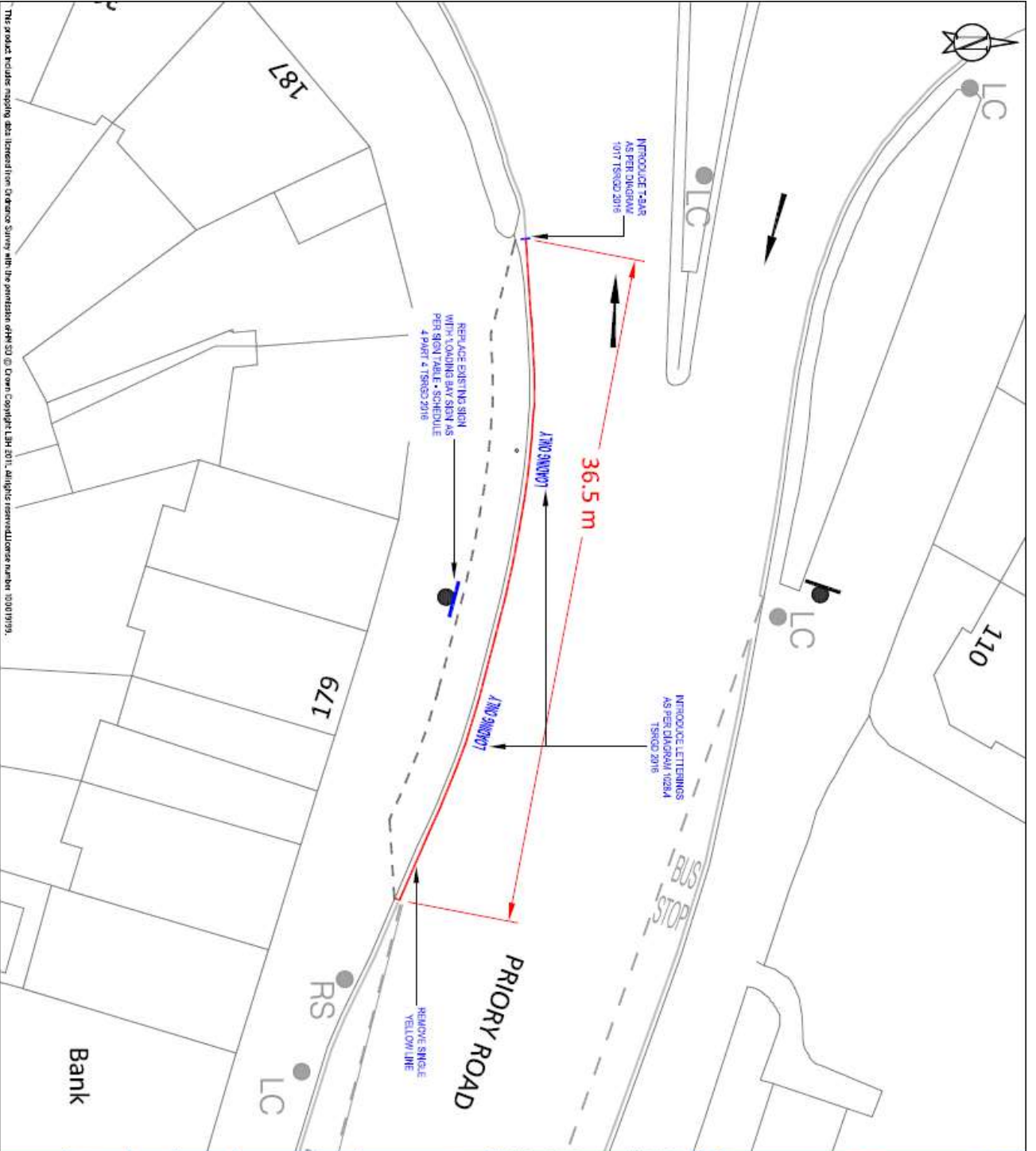

The project includes mapping data licensed from Ordnance Survey with the permission of HMSO © Crown Copyright LHM 2011. All rights reserved. Licence number: 100019193.

KEY

- NEW/ Single Yellow Line
- NEW/ Double Yellow Line
- NEW/ Kerb Slip Markings
- NEW/ Parking Bay Markings
- NEW/ Disabled Parking Bay Location
- NEW/ Disabled Parking Bay Location
- NEW/ Form Post with Sign
- REMOVE Single Yellow Line
- REMOVE Double Yellow Line
- REMOVE Kerb Slip Markings
- REMOVE Parking Bay Markings
- REMOVE Form Post with Sign
- Lane Column with Sign
- Dropped Kerb/Crossover



Site Location:
OUTSIDE 175-183 PRIORITY ROAD NB

Works:
CONVERT PARKING BAY TO LOADING BAY
REMOVE SINGLE YELLOW LINE

Notes:

SCALE:
1:200 @ A3

DRAWN: AK **CHECK:** XX **DATE DRAWN:** 22/12/2020

BATCH NO. 27



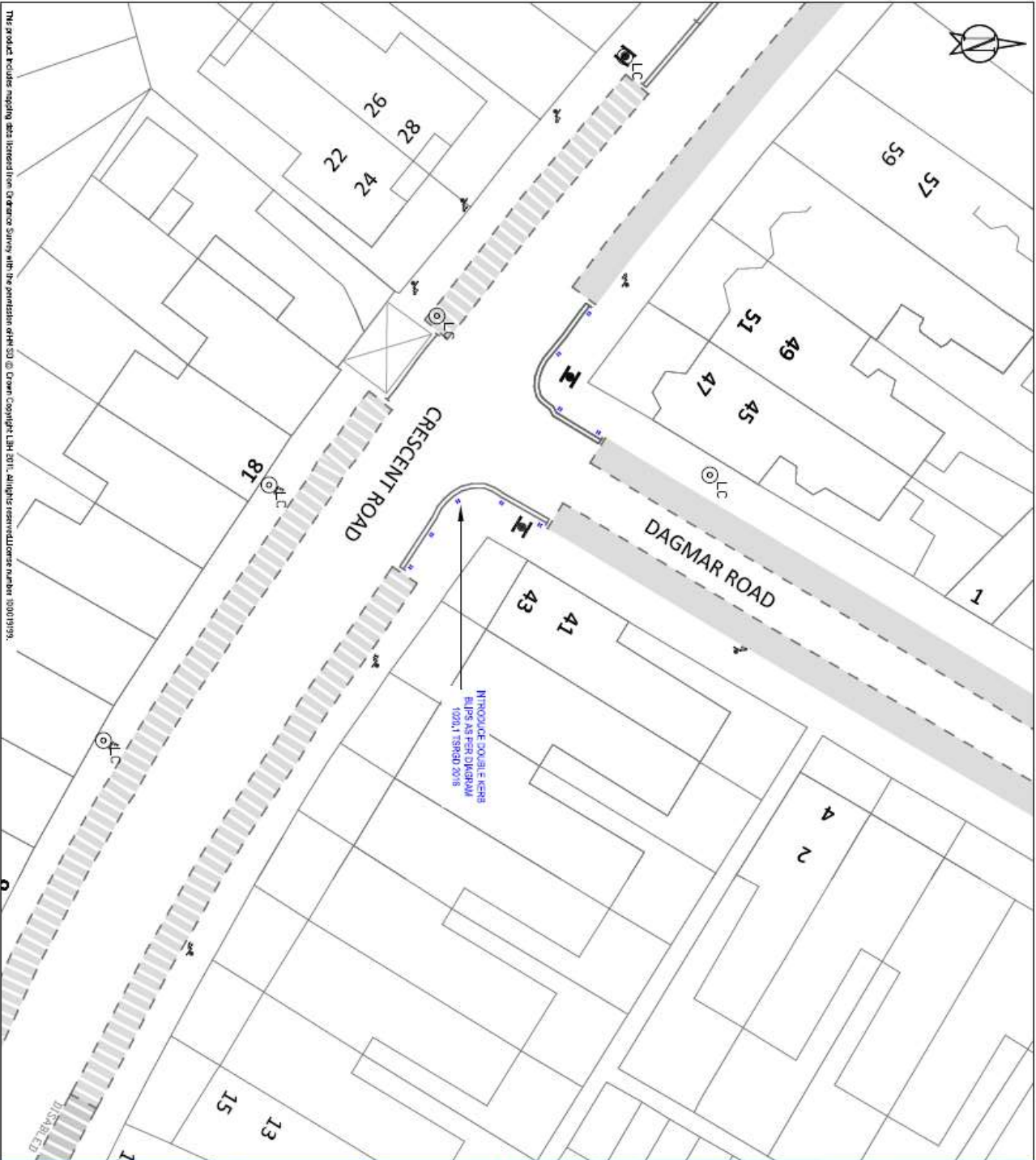

<p>KEY</p> <ul style="list-style-type: none"> NEW/ Single Yellow Line NEW/ Double Yellow Line NEW/ Kerb Blip Markings NEW/ Kerb Blip Markings NEW/ Parking Bay Markings NEW/ Disabled Parking Bay Location NEW/ Disabled Parking Bay Location NEW/ Form Post with Sign REMOVE/ Single Yellow Line REMOVE/ Double Yellow Line REMOVE/ Kerb Blip Markings REMOVE/ Parking Bay Markings REMOVE/ Form Post with Sign Lamp Column with Sign Dropped Kerb/Crossover 	<p>LOCATION PLAN</p>	
	<p>Site Location: JUNCTION WITH DAGMAR ROAD ON CRESCENT ROAD NZ2</p>	
<p>Works: INSTALL DOUBLE KERB BLIPS</p>		
<p>Notes:</p>		
<p>SCALE: 1:200 @ A3</p>		
<p>DRAWN: AK</p>	<p>CHECK: XX</p>	<p>DATE DRAWN: 18/12/2020</p>
<p>BATCH NO. 27</p>		

THE DATA INCLUDES INSPIRE DATA LICENSED FROM Ordnance Survey with the permission of the SD © Crown Copyright, LBN 2011, all rights reserved. Licence number 100010199.

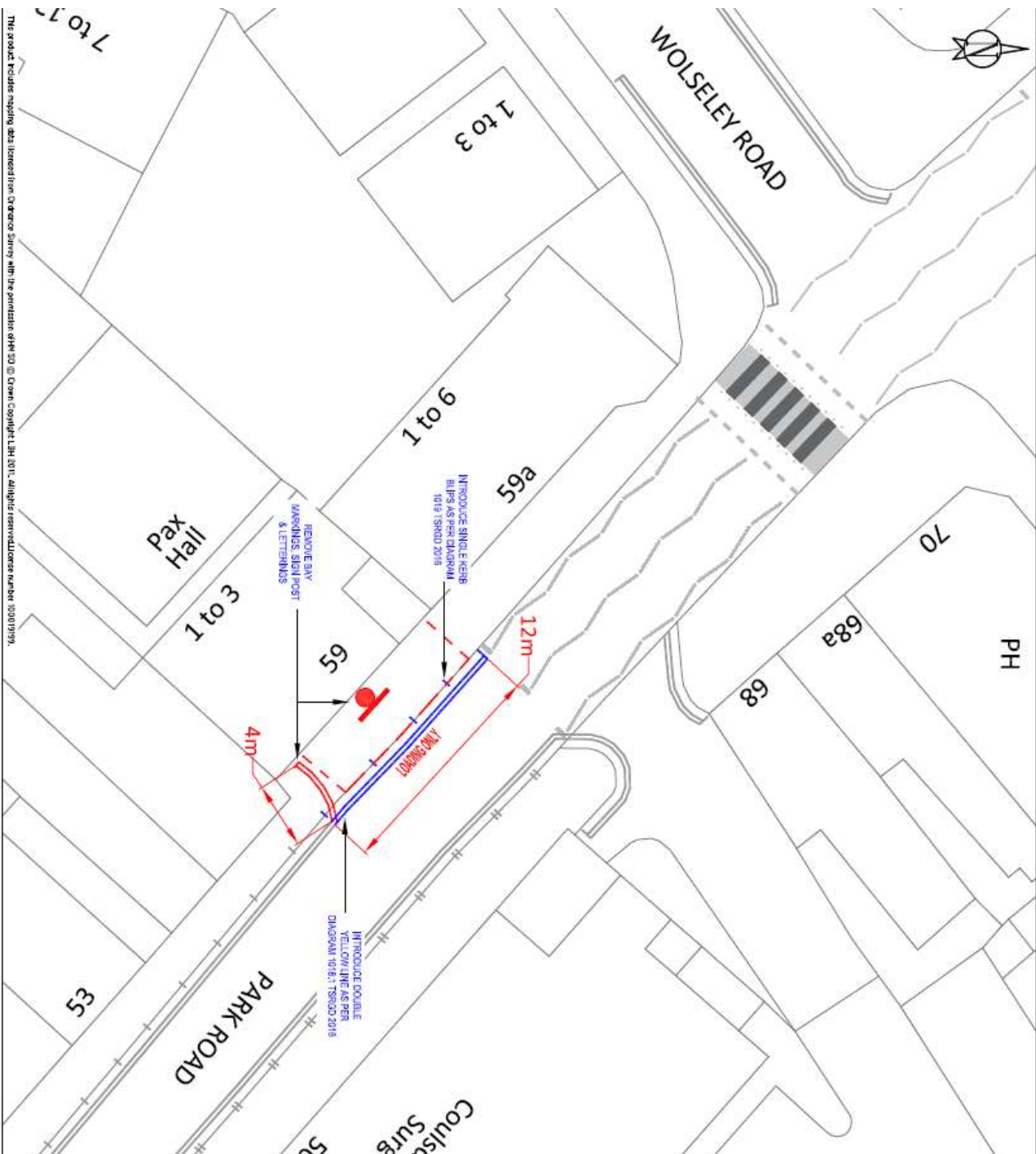

<p>KEY</p> <ul style="list-style-type: none"> NEW Double Yellow Line NEW Double Yellow Line NEW Kerb Slip Markings NEW Parking Bay Markings NEW Disabled Parking Bay Location NEW Disabled Parking Bay Location NEW 7.5m Post with Sign REMOVE Single Yellow Line REMOVE Double Yellow Line REMOVE Kerb BIP Markings REMOVE Parking Bay Markings REMOVE 7.5m Post with Sign LAMP Column with Sign Dropped Kerb/Crossover 	<p>LOCATION PLAN</p>						
	<p>Site Location:</p> <p>OUTSIDE 59 PARK ROAD NR</p>						
<p>Works:</p> <ul style="list-style-type: none"> REMOVE LOADING BAY EXTEND DOUBLE YELLOW LINES & SINGLE KERB RIPS 	<p>Notes:</p> <p>SCALE: 1:200 @ A3</p> <table border="1"> <tr> <td>DRAWN:</td> <td>CHECK:</td> <td>DATE DRAWN:</td> </tr> <tr> <td>AK</td> <td>XX</td> <td>22/12/2020</td> </tr> </table> <p>BATCH NO. 27</p>	DRAWN:	CHECK:	DATE DRAWN:	AK	XX	22/12/2020
DRAWN:	CHECK:	DATE DRAWN:					
AK	XX	22/12/2020					

Public Notice



**PROPOSED INTRODUCTION/AMENDMENT/REMOVAL OF WAITING AND LOADING RESTRICTIONS AND PARKING PLACES – VARIOUS LOCATIONS – T01
THE HARINGEY (WAITING AND LOADING RESTRICTION) (AMENDMENT NO. *) ORDER 202* AND
VARIOUS CONTROLLED PARKING ZONE AMENDMENT ORDERS**

1. NOTICE IS HEREBY GIVEN that the Council of the London Borough of Haringey proposes to make the above mentioned Orders under sections 6, 45, 46 and 124 of and Part IV of Schedule 9 to the Road Traffic Regulation Act 1984, as amended.

The general effect of the Orders would be:-

2. To extend: -

- (i) Existing double yellow line waiting restriction and double kerb marking loading restriction outside Cypriot Centre on Earham Grove N22 by 17 metres, therefore reducing the existing parking bay by 17 metres in length;
- (ii) Existing double yellow line waiting restriction on Back Lane N8, located at the rear of no. 12 Park Road N8, by 13.5 metres in length;

3. To convert: -

- (i) Existing single yellow line waiting restriction, into a double yellow line waiting restriction, operating at all times outside no. 99 Willoughby Lane N17;
- (ii) Existing single yellow line waiting restriction, into a double yellow line waiting restriction, operating at all times outside nos. 76 to 60 Willoughby Lane N17;
- (iii) Existing single yellow line waiting restriction, into a double yellow line waiting restriction, operating at all times opposite nos. 66 to 60 Willoughby Lane N17;
- (iv) Existing single yellow line waiting restriction, into a double yellow line waiting restriction 3.5 metres in length, operating at all times outside nos. 3 to 5 Durnsford Road N11;
- (v) Existing pay by phone bay into a motorcycle bay, operating at all times opposite the entrance to Cranford Industrial Estate on Tottenham Lane N8, 5 metres in length;

4. To introduce: -

- (i) Loading only bay operating Monday to Sunday from 6am-9am and 6pm-9pm, with a maximum stay period of 1 hour and no return time of 2 hours outside no. 179 to 185A Priory Road N8;
- (ii) Double yellow line waiting restriction, operating at all times outside no. 2 Rosebery Road N10;
- (iii) Double kerb marking loading restrictions, operating at all times at the junction of Crescent Road N22 and Dagmar Road, both sides;

5. To remove: -

- (i) Loading bay outside no. 59 Park Road N8, therefore extending the existing double yellow line waiting restriction by 12 metres in length;
- (ii) A single resident permit bay on Back Lane N8, located at the rear of no. 12 Park Road N8;

6. Copies of the proposed Orders, and of the Council's statement of reasons for making the Orders, and plans showing the locations and effects of the Orders may be inspected during normal office working hours until the end of a period of 6 weeks from the date on which the Orders are made or the Council decides not to make the Orders, at the reception desk, Alexandra House, 10 Station Road, Wood Green, N22 7TR or can be viewed online at www.haringey.gov.uk/traffic_orders.

7. Any person desiring to object to the proposed Orders or make other representation should send a statement in writing of either their objection and the grounds thereof or of their representation to the Traffic Management Group, River Park House, 1st floor, 225, High Road, Wood Green, N22 8HQ or to traffic.orders@haringey.gov.uk within 21 days from the date of this Notice.

Dated 6th January 2021,
Ann Cunningham - Head of Highways and Parking

APPENDIX 3

Dear all

I attach documents relating to proposed/made Traffic Orders and should be grateful for any objections or representations that you may have regarding any proposed permanent Orders within 21 days from the date of this email, and within 6 months from the in force dates for any experimental Orders. If I do not hear from you, I will assume that you have no comments to make.

Regards

Paul Chambers
Traffic Order Officer

Haringey Council
Traffic Management Group, Alexandra House, 5th Floor, 10 Station Road, Wood Green, N22 7TR

T. 020 8489 5323

E. paul.chambers@haringey.gov.uk